



RESILIENT MASONRY WALL TIES

MB04 Installation Instructions



To maintain discontinuous construction of the wall when using MB04 resilient wall ties the following installation procedure should be followed.

1. Install the MB04 resilient wall tie to the wall using Ramset 6*30mm Shuredrive™ anchors through both holes into two pre-drilled pilot holes for masonry walls. In stud walls use No. 12 Type 17 screw or equivalent to secure the MB04.
2. Install the MB04 into the bricks on the other side of the tie.
3. Remove any mortar that is in contact with the isolation foam or the centre of the tie.

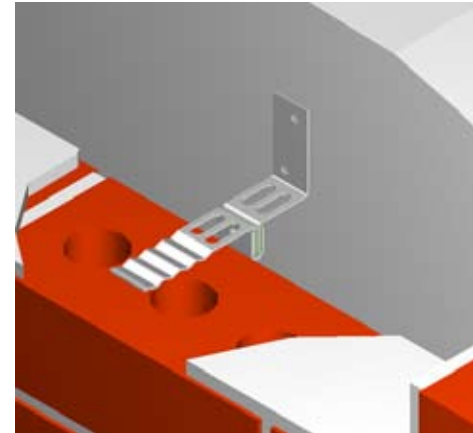

For all Installation enquiries contact Matrix Industries

www.matrixindustries.com.au

144 Oxley Island Road, Oxley Island, NSW 2430 Australia

Phone: +61 2 6553 2577 - Fax: +61 2 6553 2585

Email: info@matrixindustries.com.au